

## OFFICE / WAREHOUSE SPACE



### Property Information

- **Combination of office and warehouse space ranging in size from 1,446 sq. ft. to 1,507 sq. ft.**
- **Convenient location close to Barlow Tr., 32nd Ave NE and Deerfoot Tr.**
- **Ample parking**

Contact : **Sam Morgan 403-301-7735** [sam@target-realty.com](mailto:sam@target-realty.com)

Target Realty Corp. 134, 6170 - 12th Street SE, Calgary AB T2H 2X2 Tel. 403-253-3060 Fax 403-253-3221 [www.target-realty.com](http://www.target-realty.com)

DISCLAIMER: Each page of this information package is intended for the information purposes only and contains information obtained from other sources believed to be correct but which does not form part of any present or future contract. Target Realty Corp. assumes no responsibility for the degree of accuracy of such information contained herein. Prices or rates quoted do not include the Goods and Services Tax. This property is subject to change and/or withdrawal from the market without notice HA 04/10

## 2928 - 18th Street NE

### FEATURES

Loading:	12' x 12' O/H Drive-in doors
Ceiling Height:	up to 18'
Power:	200 amps (TBV)
Basic Rate:	\$12.00 psf
OP Costs	\$ 3.95 psf (estimated for 2009)
Possession	immediate (depending on the unit)

### DESCRIPTION OF AVAILABLE UNITS

UNIT	TYPE	FLOOR AREA (SQ. FT.)	OFFICE	WAREHOUSE	MEZZANINE
4	Office/Whse	1,507	750	757	750
5	Office/Whse	1,507	750	757	750
6	Office/Whse	1,446	350	1,096	350
7	Office/Whse	<b>Leased</b> 1,507	503	1,004	503
10	Office	<b>Leased</b> 1,060	1,060	—	—
11	Office	<b>Leased</b> 1,060	1,060	—	—
12	Office/Storage	<b>Leased</b> 600	300	300	300
15	Office/Whse	<b>Leased</b> 1,186	300	886	300

Note: Office areas for office/whse and office/storage are approximate



# target

realty corp.™

Commercial Real Estate Services

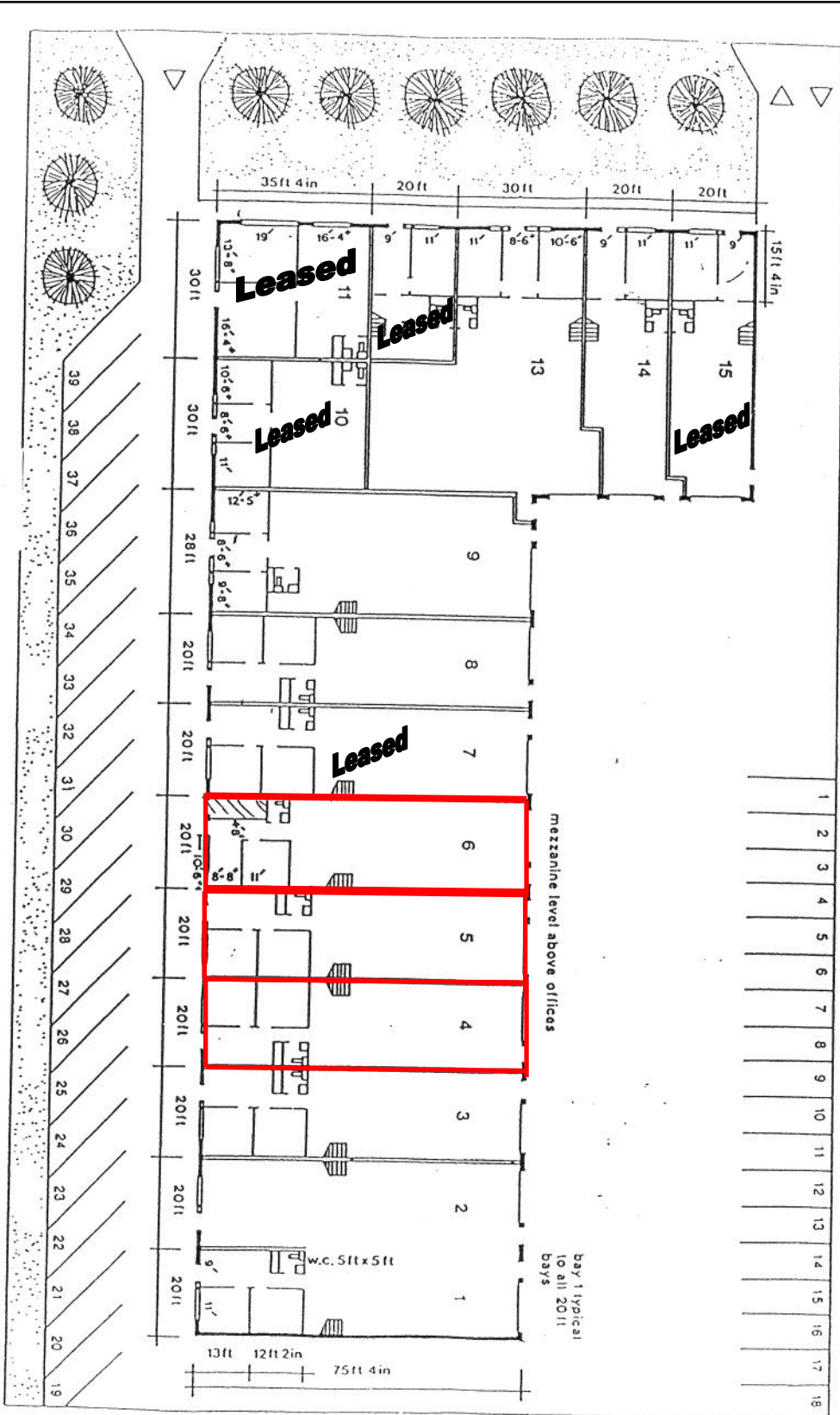

2928 - 18 Street N.E.



**target**  
realty corp.™

Commercial Real Estate Services

