

# Lease

## FEATURES

- Zoning - I - C
- Excellent exposure to Barlow Trail
- Easy access to major roadways
- Close proximity to Calgary International Airport

Ralph Gibson  
403-560-2057  
ralph@target-realty.com

Target Realty Corp.  
134, 6170 - 12<sup>th</sup> Street SE  
Calgary, Alberta T2H 2X2  
Phone 403-253-3060  
Fax 403-253-3221  
Info@Target-Realty.com



**#4, 2520 - 23 St. NE**

## Property Highlights

|           |  |
|-----------|--|
| Size:     | 1,920 sq. ft.                          |
| Loading:  | 12' x 12' Drive in                     |
| Ceiling:  | 14'                                    |
| Power:    | 100 amp                                |
| Signage:  | Optional pylon signage<br>if available |
| Rate:     | \$12.00                                |
| Op Costs: | \$ 5.29 (includes water)               |

[www.Target-Realty.com](http://www.Target-Realty.com)

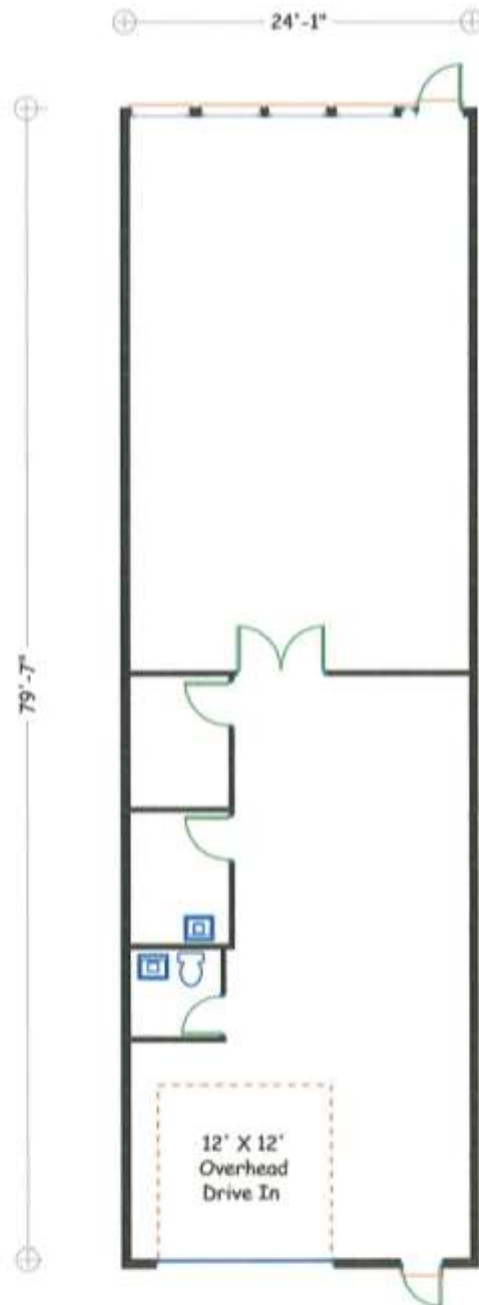

Bay 4, 2520 - 23 Street NE  
Calgary, Alberta